

CHARME

SPECIFICATIONS

MOUNTING		WALL
POWER	[W]	2x3
LAMP		built-in LED
LUMINOUS FLUX*	[lm]	2x150
LIGHT COLOUR	[K]	3000
CRI		>80
BEAM ANGLE	[°]	-
AVERAGE LIFETIME	[h]	L80/B50.000
LUMINOUS EFFICACY	[lm/W]	50
POWER SUPPLY	[V] [A]	220-240V AC 50/60 Hz
LED-DRIVER		INCLUDED
DIMMING		NO
THROUGH-WIRING		NO
MATERIAL		PLASTER
INGRESS PROTECTION		IP20
PROTECTION CLASS		I
NET WEIGHT	[kg]	0,64
GROSS WEIGHT	[kg]	0,65
COLOUR (HOUSING)		WHITE



LIGHT DISTRIBUTION

n/a

*Luminous flux values are nominal LED data at a operating temperature of 25° C

OPTIONS / OPTIONAL ACCESSORIES

Colours

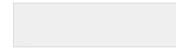

white

MOUNTING DIMENSIONS (DRILLING TEMPLATE)

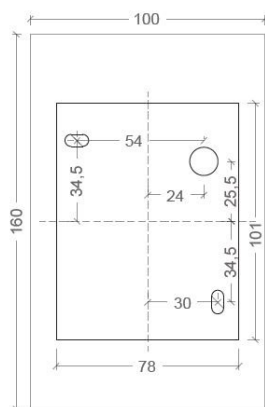

FIXTURE DIMENSIONS

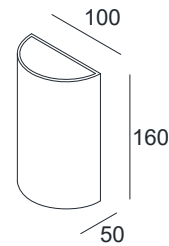

IP20

DLS LIGHTING

www.dslighting.com

***DLS**
LIGHTING