

# PHOENIX

## SPECIFICATIONS

<b>MOUNTING</b>		<b>CEILING RECESSED</b>
POWER	[W]	13
LAMP		built-in LED
LUMINOUS FLUX*	[lm]	1208
LIGHT COLOUR	[K]	2700
CRI		>90
BEAM ANGLE	[°]	125
AVERAGE LIFETIME	[h]	L80/B50.000
LUMINOUS EFFICACY	[lm/W]	92
<b>POWER SUPPLY</b>		350mA CC
LED-DRIVER	[V] [A]	NOT INCLUDED
DIMMING		SEE DRIVER
THROUGH-WIRING		SEE DRIVER
<b>MATERIAL</b>		ALUMINUM / ACRYLIC GLASS
INGRESS PROTECTION		IP44
PROTECTION CLASS		III
NET WEIGHT	[kg]	0,29
GROSS WEIGHT	[kg]	0,30
<b>COLOUR (HOUSING)</b>		WHITE ~RAL9003 / OPAL WHITE
CUT-OUT	[mm]	Ø82
RECESSED DEPTH (H)	[mm]	45

\*Luminous flux values are nominal LED data at a operating temperature of 25° C



## LIGHT DISTRIBUTION 125°

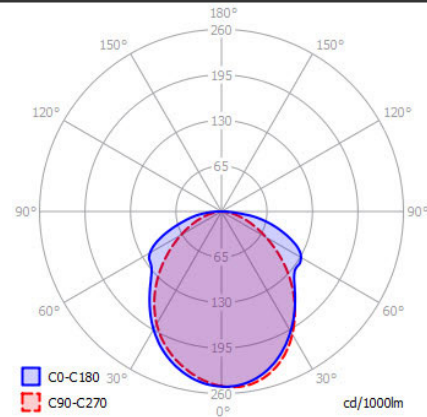

## OPTIONS / OPTIONAL ACCESSORIES

### Colours

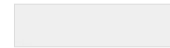

white

## CUT OUT DIMENSIONS

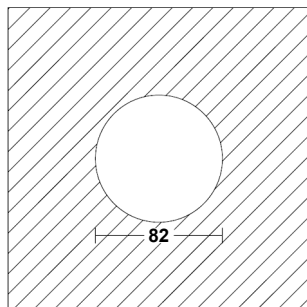

## FIXTURE DIMENSIONS

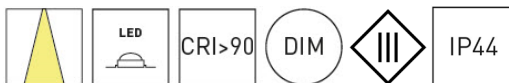
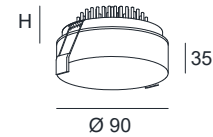

DLS LIGHTING

www.dslighting.com

**\*DLS**  
LIGHTING